

THIS COPY IS PROVIDED ON A RESTRICTED BASIS AND IS NOT TO BE USED IN ANY WAY DETRIMENTAL TO THE INTERESTS OF PANDUIT CORP.

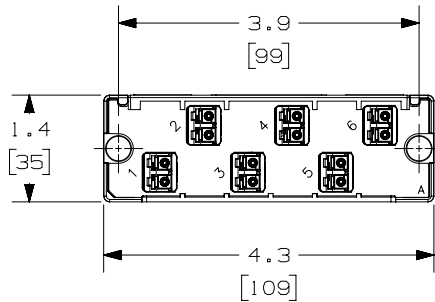

**FRONT VIEW**  
SHOWN W/O DUSTCAPS

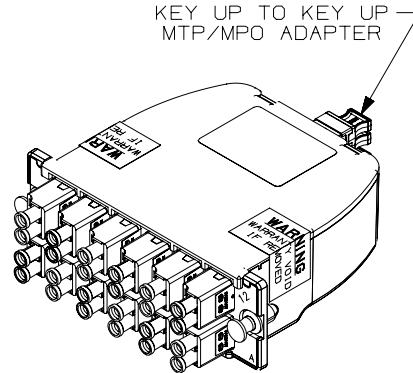
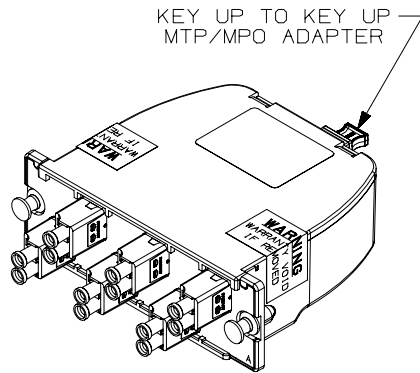
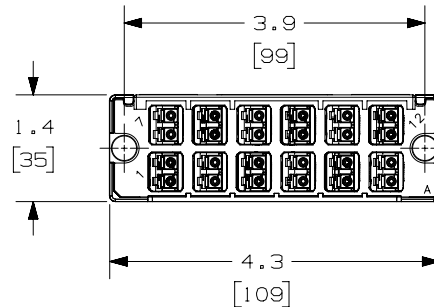

- NOTES:**
- SEE CURRENT CATALOG FOR PART NUMBER SUFFIXES TO INDICATE COLOR AND/OR PACKAGE QUANTITIES.
  - SEE CATALOG FOR COMPLETE LIST OF PARTS APPLICABLE FOR USE WITH THIS PRODUCT.
  - PART NUMBERS:**
    - SEE SHEET 2 FOR 12 FIBER.
    - SEE SHEET 3 FOR 24 FIBER.
  - CASSETTES COMPLY WITH ANSI/TIA-568 SEE ANSI/TIA-568 FOR POLARITY DETAILS AND EXAMPLES OF METHOD LINKS.
  - MATERIALS:**
    - BOX AND LID: PLASTIC
    - ADAPTER: COMPOSITE PLASTIC
  - CASSETTE WEIGHT: 4.16oz [118g]
  - DIMENSIONS IN BRACKETS ARE METRIC.

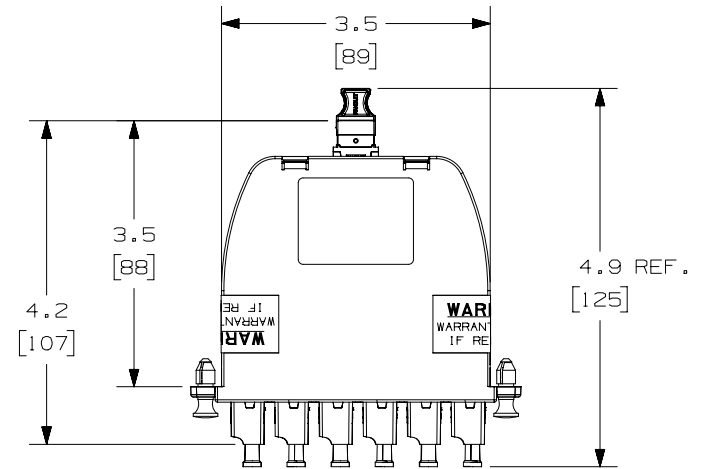

REV	DATE	BY	CHK	APR	DESCRIPTION	ECN
OOB	10/14/20	JSP	WJM	EJH	A. ADDED UNIVERSAL TO SHEET 2 AND 3.	10F113EA-DC
OOA	04-20-18	SAT	JGD	EJH	INITIAL RELEASE	10F113EA-DC

TITLE 12 & 24 FIBER DUPLEX LC CASSETTES					
CUSTOMER DRAWING					
ITEM REVISION NAME 10F113EA/00			<b>PANDUIT</b>		
DATASET FILE NAME 10F113EA_DC/00B					
UNLESS OTHERWISE SPECIFIED, DIMENSIONAL TOLERANCES ARE: IN (mm)					
.x ± .03 [ .8 ]		.xxx ± .005 [ .127 ]		MATERIAL: SEE NOTES	
.xx ± .01 [ .25 ]		ANGLES ± 5 °		DRAWING NUMBER: 10F113EA-DC	
DRAWN BY SAT			DATE 04-04-18		CHK JGD
SCALE NONE			THIRD ANGLE PROJECTION		
SHT 1 OF 3				SIZE A	

THIS COPY IS PROVIDED ON A RESTRICTED BASIS AND IS NOT TO BE USED IN ANY WAY DETRIMENTAL TO THE INTERESTS OF PANDUIT CORP.

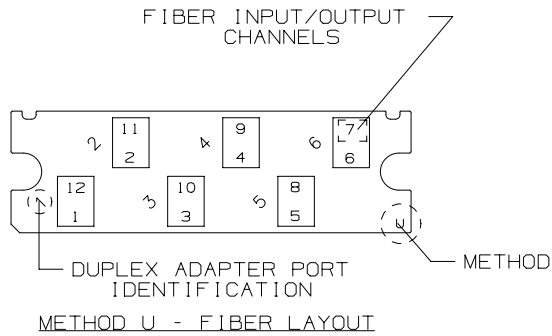

12 FIBER DUPLEX LC CASSETTE		
CASSETTE MODEL	DESCRIPTION	POLARITY METHOD
FCWZO-12-10AS	6 DUPLEX LC FIBER CASSETTE ADAPTER PLATE - METHOD A, STANDARD	STANDARD METHOD A ONLY
FCW9N-12-10AS		
FCWZO-12-10AF	6 DUPLEX LC FIBER CASSETTE ADAPTER PLATE - METHOD A, PAIR FLIPPED	FLIPPED METHOD A ONLY
FCW9N-12-10AF		
FCWZO-12-10B1	6 DUPLEX LC FIBER CASSETTE ADAPTER PLATE - METHOD B1	METHOD B1 ONLY
FCWZO-12-10B2	6 DUPLEX LC FIBER CASSETTE ADAPTER PLATE - METHOD B2	METHOD B2 ONLY
FCW90-12-10U	6 DUPLEX LC FIBER CASSETTE ADAPTER PLATE - METHOD A, STANDARD	METHOD U ONLY
FCW9N-12-10U		

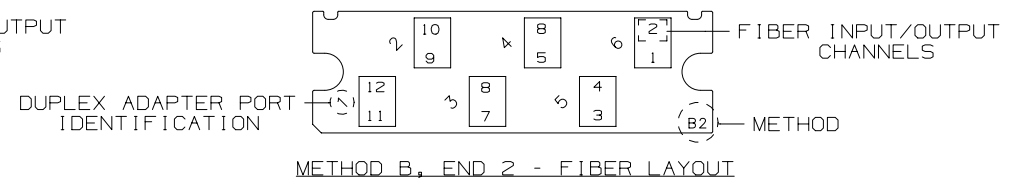
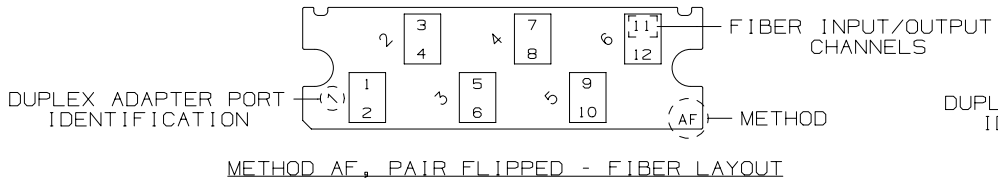
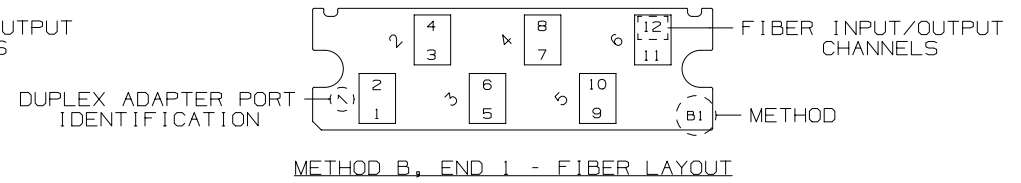
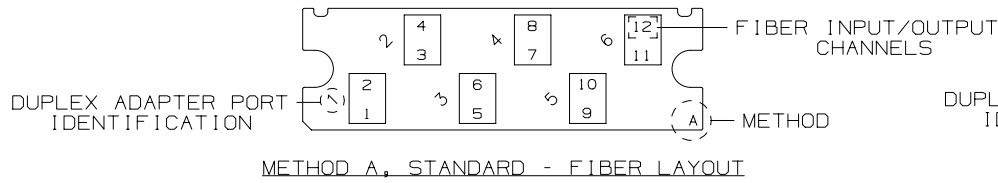

SEE SHEET 1 FOR REVISION HISTORY

TITLE  
12 & 24 FIBER DUPLEX LC CASSETTES

CUSTOMER DRAWING

ITEM REVISION NAME  
10F113EA/00

DATASET FILE NAME  
10F113EA\_DC/00B

UNLESS OTHERWISE SPECIFIED,  
DIMENSIONAL TOLERANCES ARE: IN (mm)

.x ± .03 ( .8 )      .xxx ± .005 ( .127 )  
.xx ± .01 ( .25 )      ANGLES ± 5 °

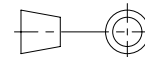

THIRD ANGLE  
PROJECTION

MATERIAL:  
SEE NOTES SHEET 1

DRAWING NUMBER:  
10F113EA-DC

REV	DATE	BY	CHK	APR	DESCRIPTION	ECN	DRAWN BY	DATE	CHK	SCALE	SHT 2 OF 3	SIZE
							SAT	04-04-18	JGD	NONE		A

THIS COPY IS PROVIDED ON A RESTRICTED BASIS AND IS NOT TO BE USED IN ANY WAY DETRIMENTAL TO THE INTERESTS OF PANDUIT CORP.

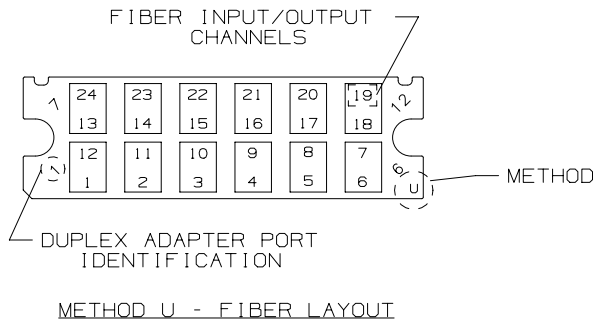

24 FIBER DUPLEX LC CASSETTE		
CASSETTE MODEL	DESCRIPTION	POLARITY METHOD
FCWZO-24-10AS	12 DUPLEX LC FIBER CASSETTE ADAPTER PLATE - METHOD A, STANDARD	STANDARD METHOD A ONLY
FCW9N-24-10AS		
FCWZO-24-10AF	12 DUPLEX LC FIBER CASSETTE ADAPTER PLATE - METHOD A, PAIR FLIPPED	FLIPPED METHOD A ONLY
FCW9N-24-10AF		
FCWZO-24-10B1	12 DUPLEX LC FIBER CASSETTE ADAPTER PLATE - METHOD B1	METHOD B1 ONLY
FCWZO-24-10B2	12 DUPLEX LC FIBER CASSETTE ADAPTER PLATE - METHOD B2	METHOD B2 ONLY
FCW90-24-10U	12 DUPLEX LC FIBER CASSETTE ADAPTER PLATE - METHOD A, STANDARD	METHOD U ONLY
FCW9N-24-10U		

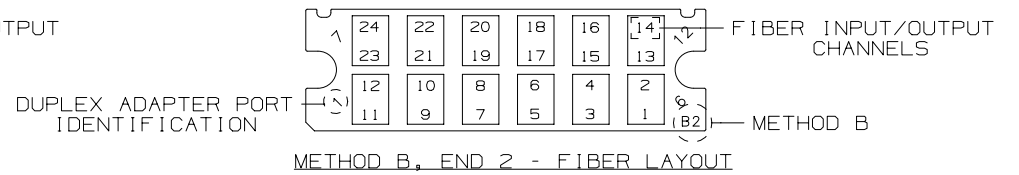
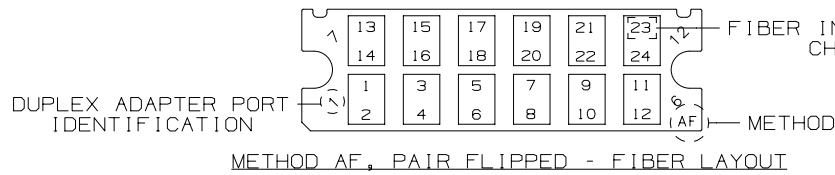
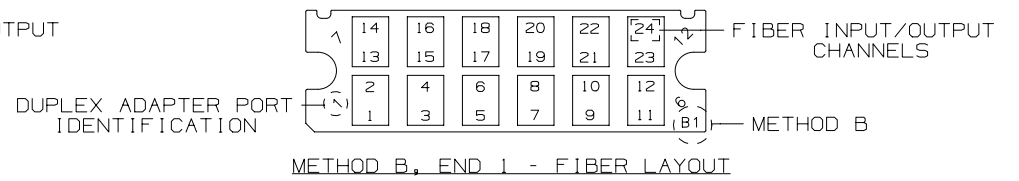
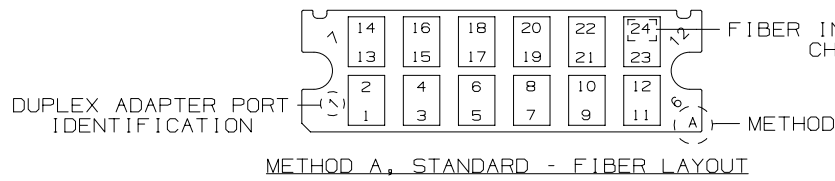

REV	DATE	BY	CHK	APR	DESCRIPTION	ECN
					SEE SHEET 1 FOR REVISION HISTORY	

TITLE 12 & 24 FIBER DUPLEX LC CASSETTES CUSTOMER DRAWING					
ITEM REVISION NAME 10F113EA/00					
DATASET FILE NAME 10F113EA_DC/00B					
UNLESS OTHERWISE SPECIFIED, DIMENSIONAL TOLERANCES ARE: IN (mm) .x ± .03 (.8)      .xxx ± .005 (.127) .xx ± .01 (.25)      ANGLES ± 5 °					
MATERIAL: SEE NOTES SHEET 1					
DRAWING NUMBER: 10F113EA-DC					
DRAWN BY SAT	DATE 04-04-18	CHK JGD	SCALE NONE	SHT 3 OF 3	SIZE A

SEE SHEET 1 FOR REVISION HISTORY

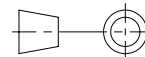

THIRD ANGLE PROJECTION