

THIS COPY IS PROVIDED ON A RESTRICTED BASIS AND IS NOT TO BE USED IN ANY WAY DETRIMENTAL TO THE INTERESTS OF PANDUIT CORP.

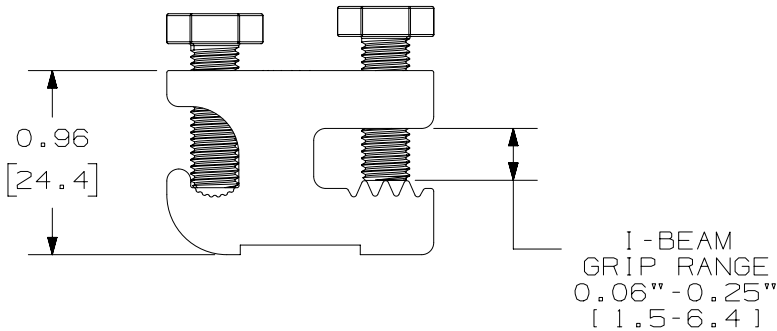
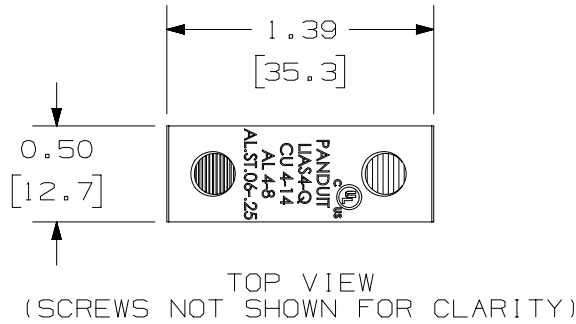

NOTES:

1. VISIT OUR ON-LINE CATALOG AT [WWW.PANDUIT.COM](http://WWW.PANDUIT.COM) FOR A LIST OF CURRENT PARTS APPLICABLE FOR USE WITH THIS PRODUCT.
2. DIMENSIONS IN [ ] ARE METRIC.
3. WEIGHT: 0.071bs [33.5g]
4. PART INCLUDES: (2) STAINLESS STEEL HEX HEAD SCREWS COLOR GREEN
5. WIRE RANGE COPPER (STRANDED AND SOLID) #14 TO #4
6. WIRE RANGE ALUMINIUM (STRANDED) #8 TO #4
7. COMPLIANCE:
  - UL 467: GROUNDING AND BONDING
  - UL 2703: PHOTOVOLTAIC SYSTEMS

SCREW PENETRATES BEAM SURFACE PAINT/OXIDE FOR ELECTRICAL CONTACT

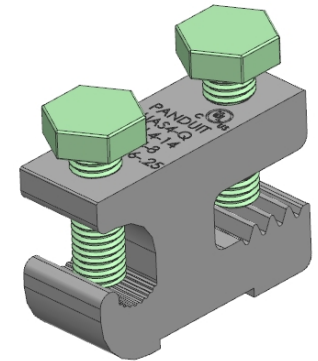

ISO VIEW

TORQUE GUIDE

WIRE SIZE (AWG)	CLAMP TORQUE ALUMINUM WIRE STRANDED in-lb [N-m]	CLAMP TORQUE COPPER WIRE SOLID AND STRANDED in-lb [N-m]	FLANGE CLAMP TORQUE in-lb [N-m]
14	-	20 [2.26]	70 [7.91]
12	-	25 [2.82]	70 [7.91]
10	-	40 [4.52]	70 [7.91]
8	30 [3.39]	50 [5.65]	70 [7.91]
6	35 [3.95]	60 [6.78]	70 [7.91]
4	40 [4.52]	70 [7.91]	70 [7.91]

PART NUMBER		L I A S 4 - Q		
TITLE				
L A Y - I N G R O U N D I N G L U G				
CUSTOMER DRAWING				
ITEM REVISION NAME		01217NAB/01		
DATASET FILE NAME		01217NAB_DC/01B		
		THIRD ANGLE PROJECTION		
MATERIAL		ALUMINIUM		
DRAWING NUMBER		01217NAB-DC		
REV	DATE	BY	CHK	SCALE
01B	04-02-24	JBN	JOCI	1:1
DESCRIPTION		SHEET 1 OF 1		
ECN		A		

01B	04-02-24	JBN	JOCI	MRJS	BRIB	INITIAL RELEASE	003496/00
REV	DATE	BY	CHK	APR	DESCRIPTION		ECN