

THIS COPY IS PROVIDED ON A RESTRICTED BASIS AND IS NOT TO BE USED IN ANY WAY DETRIMENTAL TO THE INTERESTS OF PANDUIT CORP.

PANDUIT P/N	WEIGHT
PWBTB4**	.18 LBS/EACH (81.6g)/EACH

NOTES:

1. DIMENSIONS IN [] ARE METRIC.
2. PART INCLUDES 1 BRACKET
3. PART WORKS WITH ALL 4" WIDE WIRE BASKETS.
4. BRACKET ACCEPTS UP TO 1/2" OR 12mm CUSTOMER SUPPLIED MOUNTING HARDWARE
5. BASKETS ARE MOUNTED TO TRAPEZE BRACKET WITH 2 PWBHK**. (SOLD SEPARATELY).
6. **= BL (BLACK POWDER COAT), WH (WHITE POWDER COAT), OR EZ (CLEAR ZINC)
7. ALL MATERIALS AND COMPONENTS USED MEET THE MATERIAL RESTRICTIONS OF RoHS (EUROPEAN DIRECTIVE 2011/65/EC ON THE RESTRICTION OF HAZARDOUS SUBSTANCES) AS PROPOSED BY THE RoHS TECHNICAL ADAPTATION COMMITTEE.

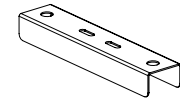
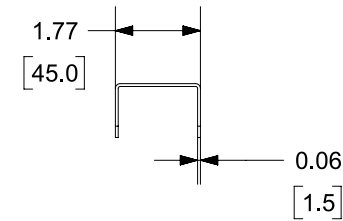
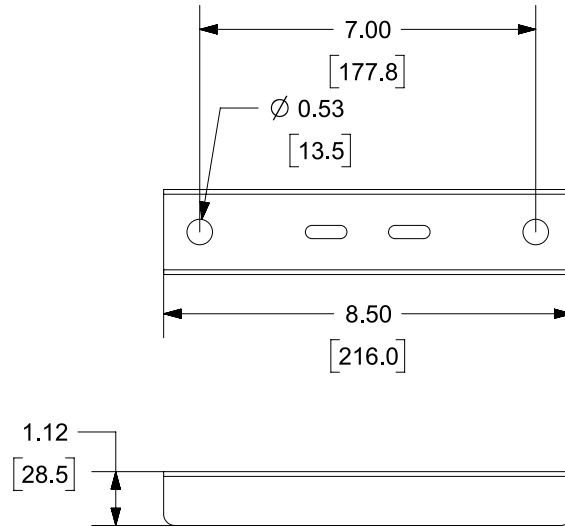

REV	DATE	BY	CHK	APR	DESCRIPTION	ECN
02C	12-15-23	SAT	DWR	EB	B. UPDATED TITLE.	00510ERF-DC
02B	3/7/22	JSP	DWR	ML	A. ADD NOTE 3-7	00510ERF-DC
02A	6/2/21	JSP	WJM	ML	INITIAL RELEASE	00510ERF-DC

TITLE WIRE BASKET TRAPEZE BRACKET 4" [100mm] W					
CUSTOMER DRAWING					
ITEM REVISION NAME 00510ERF/02			PANDUIT		
DATASET FILE NAME 00510ERF_DC_02C					
DRAWN BY JSP		DATE 6/2/21	CHK WJM	SCALE NONE	DRAWING NUMBER 00510ERF-DC
MATERIAL C.R.S.					SHEET 1 OF 1
					SIZE A

A-SIZE CUSTOMER