

THIS COPY IS PROVIDED ON A RESTRICTED BASIS AND IS NOT TO BE USED IN ANY WAY DETRIMENTAL TO THE INTERESTS OF PANDUIT CORP.

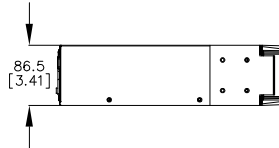
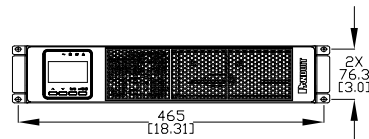
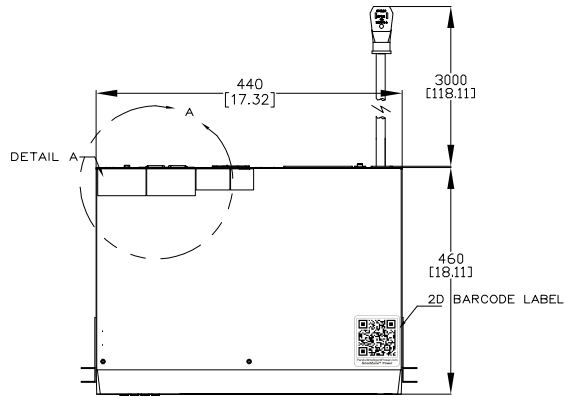
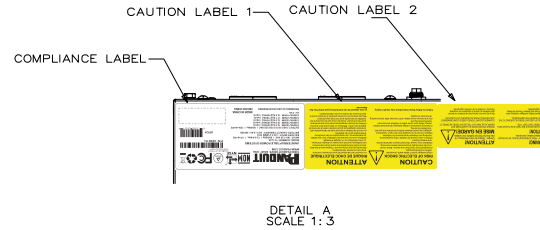
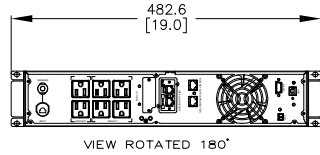

**SPECIFICATION:**

**1. STANDARD:**

UPS TOPOLOGY:	LINE INTERACTIVE
KVA:	1.5
BATTERY TYPE:	LITHIUM-ION
INPUT PLUG:	NEMA 5-15P
NOMINAL INPUT VOLTAGE:	100/110/115/120/125VAC
INPUT PHASE:	SINGLE
OUTPUT PHASE:	SINGLE
NOMINAL OUTPUT VOLTAGE:	100/110/115/120/125VAC
OUTLET TYPE AND QTY:	NEMA 5-15R(6)
DISPLAY TYPE:	2.8 INCH, 4 BUTTON
PARALLEL PORT SUPPORT:	NO
INPUT BREAKER TYPE:	25A PUSH BUTTON
OUTPUT BREAKER TYPE:	N/A

**2. ADDITIONAL:**

NONE

**3. ACCESSORY COMPONENTS:**

P/N U02N11L CONTAINS AN INTELLIGENT NETWORK CARD,(INSTALLED)  
 STABILIZER BRACKET, QTY:(4)  
 INSTALLATION EARS, QTY:(2)  
 SAFETY WARNING SHEET,QTY:(1)  
 SELECTION GUIDE(POCKET GUIDE),QTY:(1)  
 DB9/DB9 RS232 1.5M COMMUNICATION CABLE, QTY:(1)  
 USB-A/USB-B 1.2M SERIAL COMMUNICATION CABLE, QTY:(1)  
 INCLUDES P/N:ULC048 INTERNAL BATTERY CARTRIDGE, QTY (1),(INSTALLED)  
 INCLUDES P/N:URMKIT2 INSTALLATION RAIL KIT, QTY (1),(U02N11L ONLY)  
 REFER TO ASSOCIATED DRAWINGS FOR PHYSICAL DIMENSIONS AND SPECIFICATIONS  
 EPO PLUG WITH SHORTING WIRE,QTY:(1),(INSTALLED)

**NOTES:**

1. PRIMARY DIMENSIONS ARE IN MILLIMETERS. SECONDARY DIMENSIONS ARE IN INCHES.
2. INSTALLATION SHALL COMPLY WITH ALL APPLICABLE NATIONAL, STATE, AND LOCAL CODES.
3. VISIT OUR ON-LINE CATALOG AT [WWW.PANDUIT.COM](http://WWW.PANDUIT.COM) FOR A CURRENT LIST OF PRODUCTS APPLICABLE FOR USE WITH THIS PRODUCT.
4. ALL PURCHASED ITEMS CONFORM TO C2-0834 PANDUIT SPECIFICATION FOR CHEMICAL SUBSTANCES TO BE CONTROLLED IN PRODUCT AND PACKAGING.

**IDENTIFICATION:**

PART NUMBER	DESCRIPTION	SHIPPING WEIGHT (KG)
U02S11L	SMARTZONE UPS, 1.5kVA, 2U, 120V, SINGLE PHASE, LITHIUM-ION POWER PROTECTION	19.8
U02N11L	SMARTZONE UPS, 1.5kVA, 2U, 120V, SINGLE PHASE, LITHIUM-ION POWER PROTECTION WITH INTELLIGENT NETWORK CARD	23.1

REV	DATE	BY	CHK	APR	DESCRIPTION	ECN
01A	01/12	LS	ZWZ	GLM/DB	A-UPDATED DESCRIPTION B-KIT WAS URMKIT 1 C-NOTCH REMOVED IN METAL	U02N11L
00A	01/12	LS	ZWZ	GLM/DB	RELEASE TO PRODUCTION	U02N11L
REV	DATE	BY	CHK	APR	DESCRIPTION	ECN

TITLE		SMARTZONE UPS U02S11L/U02N11L	
CUSTOMER DRAWING		U02S11L/U02N11L/01	
DRAWING NUMBER		U02S11L/U02N11L-DA/O1A	
DIMENSIONAL TOLERANCES UNLESS NOTED (IN)		N/A	
PANDUIT		U02N11L-DC	
DATE	01/11/2022	MD	VARIOUS
SHEET	1	TOTAL	2



**PANDUIT** NOM NYCE FC

18300 PANDUIT DRIVE, 60487, USA  
WWW.PANDUIT.COM

UNINTERRUPTIBLE POWER SYSTEMS  
MODEL NUMBER: 1C1L2A  
INPUT: 100-125 VAC | 50/60Hz | 12.0 A Max. | 1P+N+PE  
BATTERY INPUT: 52.5 V  $\pm$  5% | 50 A  
BATTERY CAPACITY/ENERGY: 48 V | 6 Ah / 288 Wh

OUTPUT: 100/110/115/120/125 VAC | 50/60Hz | 1PH+N+PE  
1500VA/1350W, 12.0 A@125VAC (input)  
1440VA/1350W, 12.0 A@120VAC (input)  
1380VA/1350W, 12.0 A@115VAC (input)  
1280VA/1150W, 11.7 A@110VAC (input)  
1200VA/1150W, 12.0 A@100VAC (input)  
Icc: 3 kA

MADE IN CHINA  
HECHO CHINA

UPC# 6 81050 82251 4

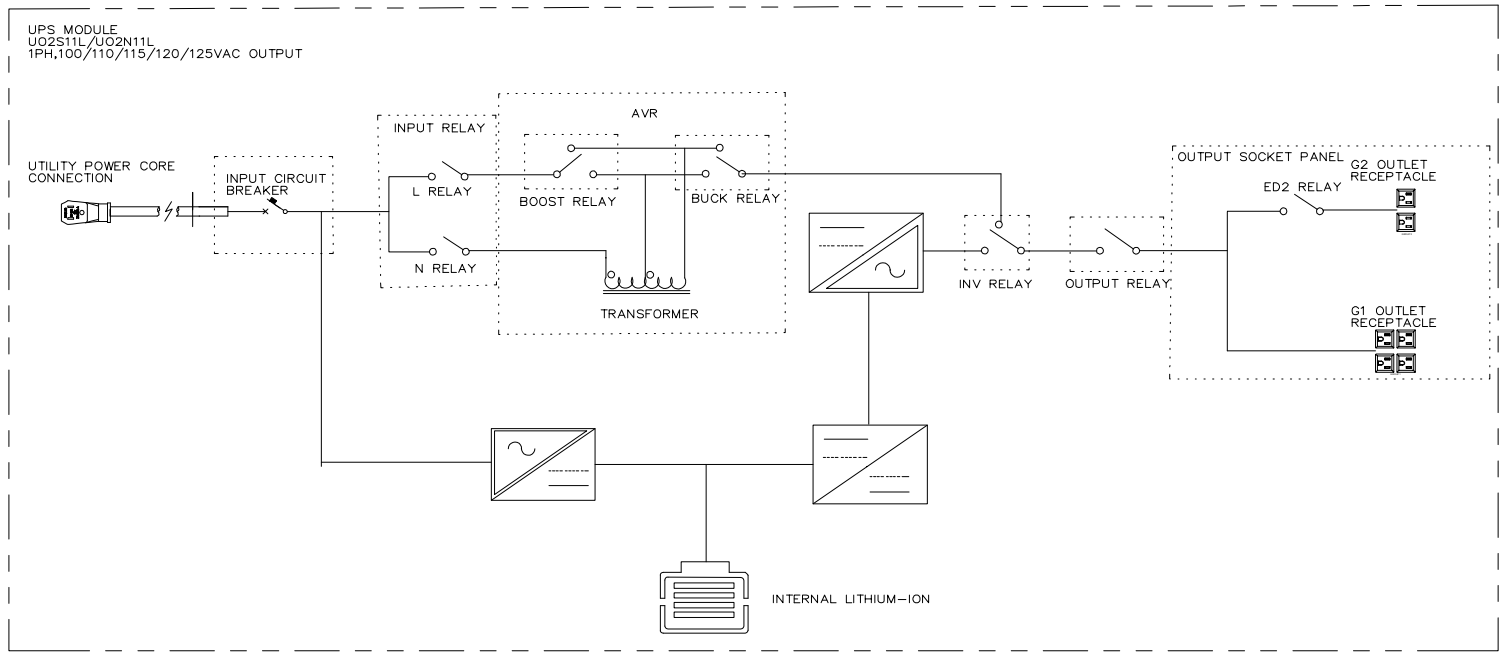

CORE FIRMWARE PART NUMBER: 3040-6390  
CORE FIRMWARE VERSION: V01B000000

LEGEND			
	CIRCUIT BREAKER		AC-DC CONVERTER
	RELAY		AC-DC INVERTER
	DC-DC CONVERTER		AC-DC CHARGER
	BATTERY		

REV	DATE	BY	CHK	APR	DESCRIPTION	ECN
01A	08/01	LS	ZRZ	GLM/DJB	A-UPDATED DESCRIPTION B-KIT WAS JURKIKIT 1 C-NOTCH REMOVED IN METAL.	U02N11L
00A	01/18	LS	ZRZ	GLM/DJB	RELEASE TO PRODUCTION	U02N11L
REV	DATE	BY	CHK	APR	DESCRIPTION	ECN

WE ARE THAT YOU OVER FULFILL THE REQUIREMENT. WE CAN TAKE THE CLIENT TO THE NEXT LEVEL. WE CAN TAKE THE CLIENT TO THE NEXT LEVEL. WE CAN TAKE THE CLIENT TO THE NEXT LEVEL.	
TITLE: SMARTZONE UPS U02S11L/U02N11L CUSTOMER DRAWING	DRAWN: N/A
U02S11L/U02N11L/01 U02S11L/U02N11L-DA/01A	DIMENSIONAL TOLERANCES ARE: MM (IN)
THIRD ANGLE PROJECTION	U02N11L-DC
DATE: 01/11/2022 TIME: MJD SCALE: VARIOUS	SHEET: 1 OF 2

18300007A