

ORIENTATION AND LOCATION OF BRACKETS MAY BE DETERMINED BY INSTALLER, SIZE OF CABINET, AND PDU SOLUTION

HARDWARE INCLUDED

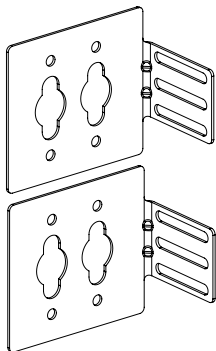

[2] PDU BRACKETS

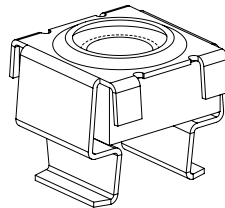

[6] M6 CAGE NUT

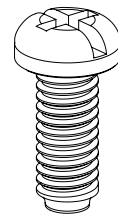

[6] M6 SCREWS
(Use 8mm Hex Bit)

For Technical Support: www.panduit.com/resources/install_maintain.asp

PDU Bracket Installation

- Install [3] Cage Nuts at desired location for Top PDU Bracket
- Orient Top PDU bracket on cabinet post at desired position
- Fasten to cabinet by passing [3] M6 Torx screws through slotted holes of bracket into Cage Nuts
- Install [3] Cage Nuts at desired location for Bottom PDU Bracket
- Orient Bottom PDU bracket on cabinet post at desired position
- Fasten to cabinet by passing [3] M6 Torx screws through slotted holes of bracket into Cage Nuts

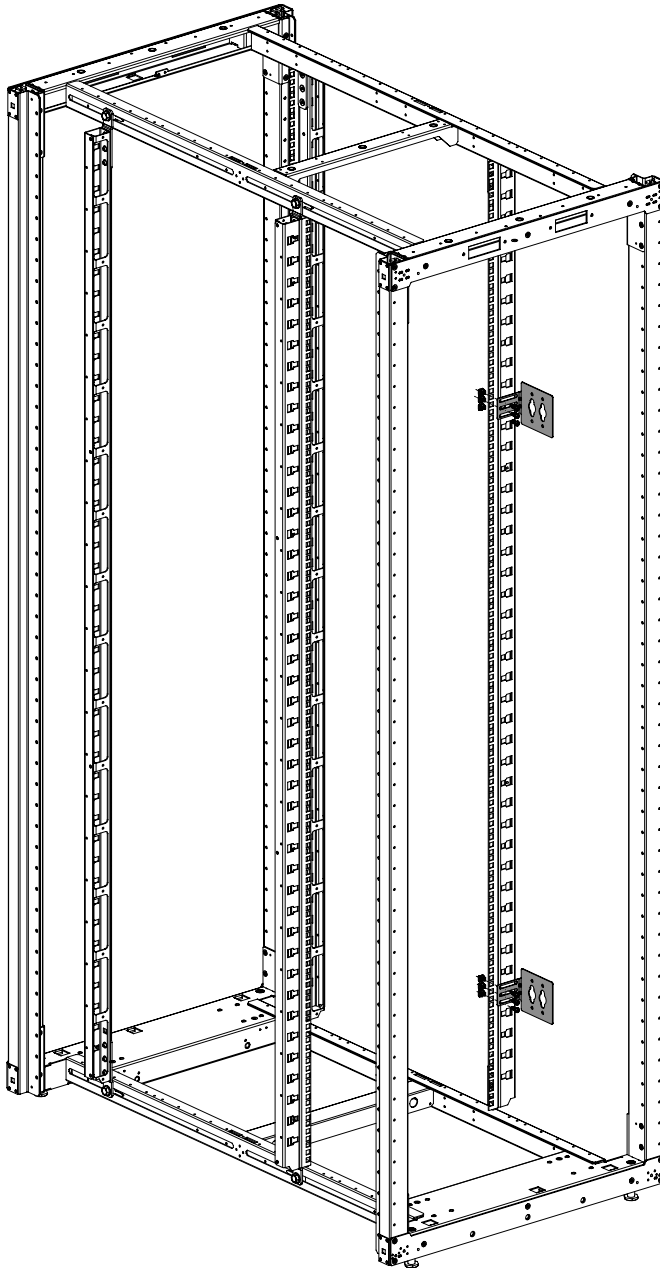

TOP BRACKET ORIENTATION EXAMPLE

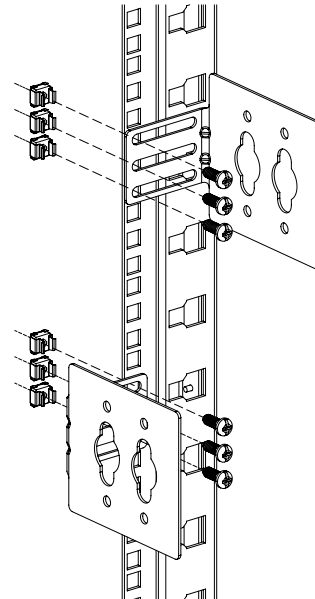

TOP BRACKET ADJUSTED TO MIN. WIDTH EXAMPLE

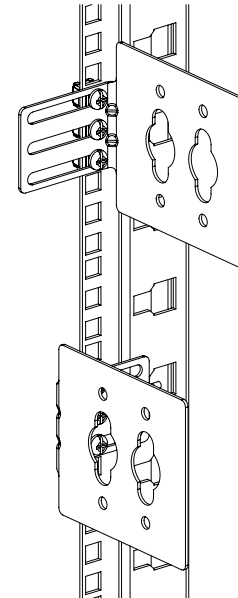

NOTES:

- An angle impact driver (such as Makita® BTL061) is recommended when installing MA019, MA019W brackets on cabinet positioned in row

For Instructions in Local Languages
and Technical Support:

www.panduit.com/resources/install_maintain.asp

PANDUIT

www.panduit.com

E-mail:
techsupport@panduit.com

Phone:
866-405-6654