

THIS COPY IS PROVIDED ON A RESTRICTED BASIS AND IS NOT TO BE USED IN ANY WAY DETRIMENTAL TO THE INTERESTS OF PANDUIT CORP.

PANDUIT PART NUMBER	WEIGHT
PWBSPL2**	0.52 LB/EACH 0.236 kg/EACH

NOTES:

- VISIT OUR ON-LINE CATALOG AT WWW.PANDUIT.COM FOR A LIST OF CURRENT PARTS APPLICABLE FOR USE WITH THIS PRODUCT.
- DIMENSIONS IN [] ARE METRIC.
- ALL MATERIALS AND COMPONENTS USED MEET THE MATERIAL RESTRICTIONS OF RoHS (EUROPEAN DIRECTIVE 2011/65/EU ON THE RESTRICTION OF HAZARDOUS SUBSTANCES) AS PROPOSED BY THE RoHS TECHNICAL ADAPTATION COMMITTEE.
- REFERENCE FS169 FOR INSTALLATION INSTRUCTIONS.
- PART NUMBER INCLUDES 12 BARS.
- USE PWBHK** FOR FASTENING TO BASKET.

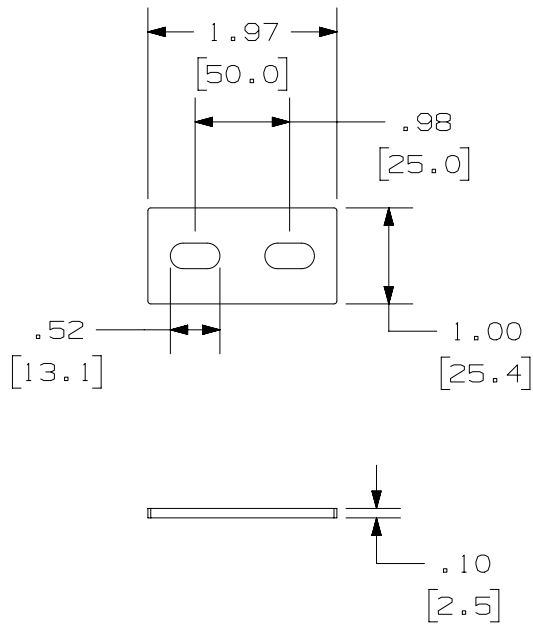

TITLE		WIRE BASKET 2-HOLE SWEEPING SPLICE BAR, (PACK OF 12)		
ITEM REVISION NAME		CUSTOMER DRAWING		
DATASET FILE NAME		00510ECG/00		
MATERIAL		00510ECG_DC/00B		
DRAWN BY		THIRD ANGLE PROJECTION		
DATE		C.R.S.		
CHK		DRAWING NUMBER		
SCALE		00510ECG-DC		
SHEET 1 OF 1		A		

REV	DATE	BY	CHK	APR	DESCRIPTION	ECN
00B	12-14-23	SAT	DWR	EB	A. UPDATED TITLE. B. REMOVED P/N FROM TITLEBLOCK.	00510ECG-DC
00A	11-01-21	SAT	DWR	ML	INITIAL RELEASE	00510ECG-DC



A-SIZE CUSTOMER